



**BAY-FRIENDLY
LANDSCAPING
AND
GARDENING**



BAY-FRIENDLY LANDSCAPING

WHAT IS BAY-FRIENDLY LANDSCAPING?

In Spring 2006, Castro Valley Sanitary District (CVSan) renovated the administrative offices' landscape to be "Bay-Friendly." The existing water-hungry, high maintenance landscape was replaced to be consistent with the 7 principles of Bay-Friendly Landscaping.

Bay-Friendly is a holistic approach to gardening and landscaping that works in harmony with the natural conditions of the San Francisco Bay Watershed. Bay-Friendly is not a particular style, but an approach. Bay-Friendly landscapers and gardeners work with nature to foster soil health, conserve water, reduce waste, and prevent pollution.

7 BAY-FRIENDLY PRINCIPLES

Here are some of the Bay-Friendly highlights of the CVSan Bay-Friendly Landscape:



- **Landscape Locally.** Climate and exposure are evaluated, soil and drainage are assessed. This knowledge is critical for selection of site-appropriate plants and materials. 45% of species in CVSan's landscape are native to the San Francisco Bay Area. Using local, natural plant communities allows the landscape to work with nature.

- **Protect Water & Air Quality.** Trees are planted to create shade, absorb air pollutants and minimize the effects of global warming. A "bioswale", or shallow depression in the ground, is created to capture storm water to allow for infiltration into the soil. This recharges ground water and removes pollutants from storm water.

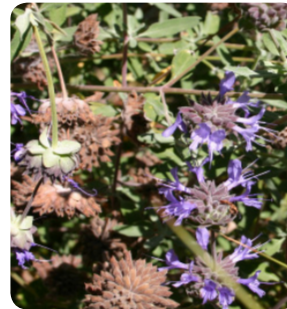

- **Create & Protect Wildlife Habitat.** 75% of plant species are native to California. Garden insects are considered valuable additions to the landscape, not pests, as they increase diversity, improving the overall health of the landscape. With 36 distinct plant species, this landscape maximizes biodiversity.

- **Conserve Water.** The renovated landscape eliminates the use of lawn, saving approximately 24,000 gallons of water each year. A high efficiency irrigation system is used. The irrigation controller measures air temperature and precipitation on-site to determine the landscape's water needs.



BAY-FRIENDLY PRINCIPLES

- **Conserve Energy.** Local products and suppliers are specified. Buying locally produced and low embodied energy products often reduces the cost of an item, as well as the hidden environmental costs, such as pollution, of transporting materials. Excavated soil is re-used on site to create a raised planting bed.
- **Nurture the Soil.** This garden is free of synthetic chemicals. Organic compost, produced with CVSsan residents' food scraps, is used to amend the soil. Sheets of re-used, flattened cardboard boxes are laid under layers of compost, soil, and recycled wood chip mulch to naturally suppress weed growth and improve soil conditions.



- **Landscape for Less to the Landfill.** Plants are placed with enough room to reach maturity without heavy shearing or pruning. Selecting appropriately sized plants fosters plant health while reducing waste and maintenance. By planting non-invasive species, waste is reduced and ecosystem diversity is protected. Recycled aluminum frames and posts hold interpretive signs.

CASTRO VALLEY SANITARY DISTRICT

The CVSsan administration building, completed in 1997, is considered a green building because of its use of recycled and recyclable materials. CVSsan is a certified Green Business by the Alameda County Green Business Program. The landscape is designed to be consistent with those "green" standards and provides an environmentally responsible model landscape for the community.



SELF-GUIDED TOUR

Designed and constructed by Four Dimensions Landscape Development Company.

It is our hope the renovated landscape serves as a demonstration of Bay-Friendly Landscaping and Gardening in the community. The same principles used in the design, construction, and maintenance of our landscape may easily be transferred to your home's garden. You are encouraged to take a self-guided tour, where you may view, first-hand, the unique beauty of Bay-Friendly landscape. Now it's your turn to get Bay-Friendly!

#	Common Name	Botanical Name	Plant Type	Approximate Size
1	Idaho Locust	<i>Robinia ambigua idahoensis</i>	Deciduous tree	40' tall
2	Manzanita	<i>Arctostaphylos 'Dr. Hurd'</i>	CA Native shrub	6-15" tall x 8-12" wide
3	Manzanita	<i>Arctostaphylos 'Emerald Carpet'</i>	CA Native shrub	12-18" tall x 3-6' wide
4	Manzanita	<i>Arctostaphylos 'Howard McMinn'</i>	CA Native shrub	5-7" tall x 6-10' wide
5	California Hazelnut	<i>Corylus cornuta californica</i>	Local Native shrub	10-15' tall
6	Ocean Spray	<i>Holodiscus discolor</i>	Local Native shrub	8' tall x 8' wide
7	Oregon Grape	<i>Mahonia aquifolium</i>	CA Native shrub	3-6' tall x 3-6' wide
8	Golden Currant	<i>Ribes aureum</i>	CA Native shrub	3-6' tall x 3-6' wide
9	Pink Currant	<i>Ribes sanguineum glutinosum</i>	Local Native shrub	5-12' tall x 5-12' wide
10	California Rose	<i>Rosa californica</i>	Local Native shrub	3' tall x 6' wide
11	Sage	<i>Salvia 'Aromas'</i>	CA Native shrub	5' tall x 5' wide
12	Snowberry	<i>Symphoricarpos albus</i>	Local Native shrub	2-5' tall x 3-5' wide
13	Pink Yarow	<i>Achillea millefolium rosea</i>	CA Native shrub	12-30" tall x 2-4' wide
14	Berkeley Sedge	<i>Carex tumulicola</i>	Local Native perennial	1-2' tall x 1-2' wide
15	Hair Grass	<i>Deschampsia caespitosa</i>	Local Native perennial	1-2' tall x 2' wide
16	California Fuchsia	<i>Epilobium canum</i>	Local Native perennial	1-2' tall x 4' wide
17	Pink Mexican Daisy	<i>Erigeron 'Moerheimii'</i>	Perennial herb	1-2' tall x 2-3' wide
18	California Fescue	<i>Festuca californica</i>	Local Native perennial	1-2' tall x 2-3' wide
19	Sand Strawberry	<i>Fragaria chiloensis</i>	Local Native perennial	6-12" tall x 18" wide
20	Allum Root	<i>Heuchera sanguinea</i>	CA Native perennial	1-2' tall x 3-4' wide
21	Douglas Iris	<i>Iris douglasiana</i>	Local Native perennial	1' tall x 3' wide
22	Green Rush	<i>Juncus effusus bruneus</i>	Local Native perennial	3' tall x 3' wide
23	Red Hot Poker	<i>Kniphofia uvaria</i>	Perennial shrub	2-3' tall x 2-3' wide
24	Deergrass	<i>Muhlenbergia rigens</i>	CA Native perennial	3-5' tall x 4' wide
25	Penstemon	<i>Penstemon 'Blue Bedder'</i>	CA Native perennial	3' tall x 6' wide
26	Western Sword Fern	<i>Polystichum munitum</i>	Local Native perennial	3-5' tall x 3-4' wide
27	Ornamental Pear	<i>Pyrus calleryana 'Chanticleer'</i>	Deciduous tree	40-60' tall
28	Blue-Eyed Grass	<i>Sisyrinchium bellum</i>	Local Native perennial	6-12" tall x 6-18" wide
29	Fringe Cups	<i>Tellima grandiflora</i>	Local Native perennial	6" tall x 2' wide
30	Woolly Thyme	<i>Thymus lanuginosus</i>	Perennial herb	2-3" tall x 3' wide
31	Blood Red Trumpet	<i>Distictus buccinatoria</i>	Perennial vine	10' tall x 6' wide
32	Creeping Thyme	<i>Thymus serpyllum</i>	Perennial herb	4-6" tall x 3' wide
33	Bougainvillea	<i>Bougainvillea spectabilis</i>	Perennial vine	8' tall x 6' wide
34	Society Garlic	<i>Tulbaghia violacea</i>	Perennial herb	1' tall x 6-8" wide
35	Sticky Monkey Flower	<i>Mimulus aurantiacus</i>	Local Native perennial	3-4' tall x 3-4' wide
36	Western Modesty	<i>Whipplea modesta</i>	CA Native perennial	1' tall x 2' wide

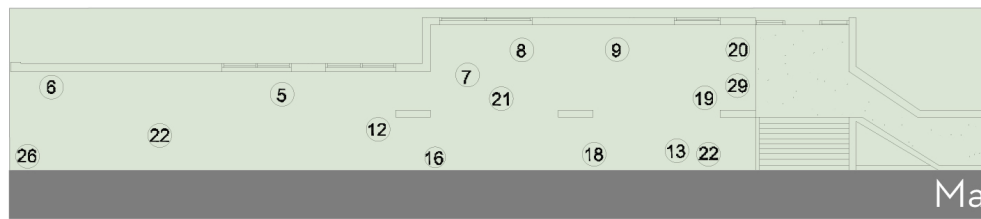

Use this map to take a self-guided tour of the landscape, where you will find 16 plant species native to the local area, and another 11 species native to California. Be sure to read the landscape signs for more information about how the landscape is "Bay-Friendly."

CASTRO VALLEY SANITARY DISTRICT
21040 Marshall Street, Castro Valley, CA 94546

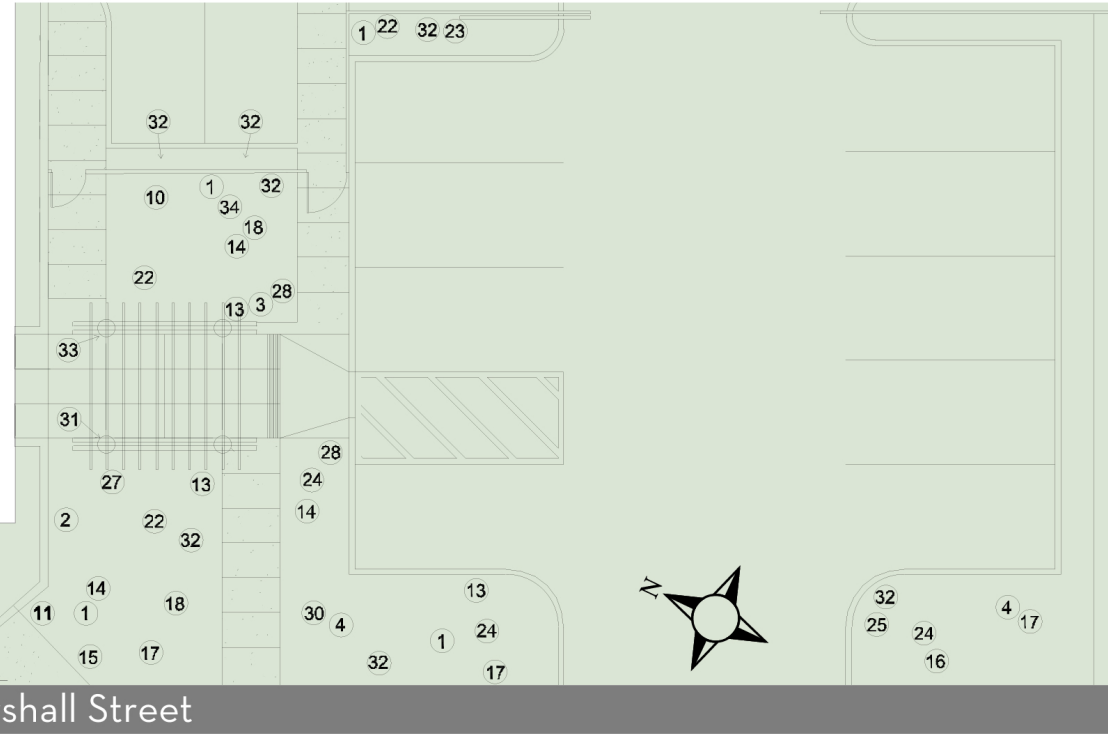



CASTRO VALLEY SANITARY DISTRICT

21040 Marshall Street

Castro Valley, CA 94546-6020

510-537-0757

www.cvsan.org

RESOURCES

Bay-Friendly Landscaping & Gardening Coalition

Visit www.BayFriendly.org or call **(510) 444-SOIL** for more information on where to find Bay-Friendly plants. Participating nurseries and garden centers stock seasonal selections of Mediterranean and California native plants. Nursery staff can assist in making sure your Bay-Friendly plant selections match the needs of your home landscape.

Information about Bay-Friendly Garden tours and Bay-Friendly publications are also available at www.BayFriendly.org.

East Bay Municipal Utility District (EBMUD)

EBMUD offers a variety of publications to keep you informed and inspired to save water in the home, garden, or business. Visit www.ebmud.com or call **(866) 403-2673** to order the award-winning "Plants and Landscapes for Summer-Dry Climates," a must-have book for the Bay-Friendly Landscaper or Gardener.